

FASSK01, Shelter Fire Safety Kit Instructions

Lighted Emergency Exit Sign

1. Remove exit sign from the transport case
2. Disconnect the carabiners connecting the two cable lanyards from on the exit sign
3. Thread cable lanyards around the frame or d-rings above your desired exit location
4. Reconnect the cable lanyard carabiners so that the exit sign hangs securely from your desired frame location.
5. Plug in a 110V AC service to the socket on the back of the exit sign.
6. Hit the power reset button on the back of the unit to reset the emergency battery backup system.





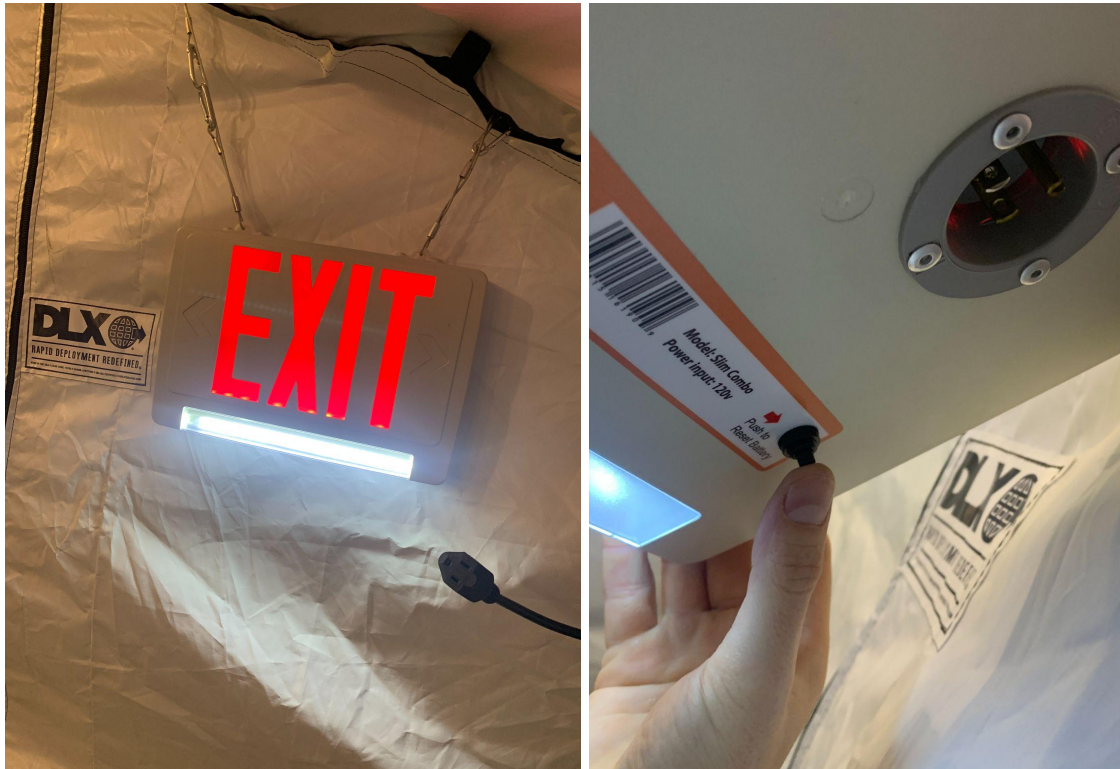

Note* The emergency battery backup system will automatically turn on when power is disrupted or disconnected from the unit. The exit sign emergency guidance light will illuminate and run for a duration of 90 mins. Hitting the reset button will turn off the battery backup system.

Smoke & Carbon Monoxide Detector

1. Remove the smoke/CO detector from the transport case
2. Use the test button located on the face of the smoke/CO detector to ensure proper function.

Note* If this is the first use, follow the instructions on the back of the detector for activating the unit.

3. Untwist the rubber coated cable tie.
4. Choose an elevated and central location within your shelter. This can be any attachment point on the frame, insulation liner, or cover material.
5. Feed the cable tie through your chosen connection point and twist the secure in place.

Note* The Smoke/CO detector should be tested regularly and replaced with a new unit when required.



Fire Extinguisher Mounting Bracket

1. Remove the fire extinguisher mounting bracket from the transport case

Note* This bracket is designed to hold up to a 5lb fire extinguisher.

2. Loosen the adjustable screw on the back side (silver) of the bracket, this will be the side that will attach to the frame of the shelter.
3. Choose the desired frame location within the shelter. If using an insulation liner, the most common attachment point is either through the endwall by creating a small separation in the hook and loop so that the frame can be accessed. If installed on an X-Series shelter with insulation, there are small access panels along the liner that line up with the vertical frame points.
4. Attach the back portion of the bracket so that it grabs on to the chosen frame location.
5. Tighten the screw to secure it in place.
6. Loosen the wingnut on the face of the bracket (Red).
7. Rotate the fire extinguisher hook so that the small tab faces up. This will orient the fire extinguisher so it is hanging vertically from the bracket.
8. Tighten the wingnut.
9. Close any insulation liner hook and loop that was opened to allow frame connection.
10. Hang a fire extinguisher on the bracket.





Deployment and Operation

- Always place a fire extinguisher in a clear unobstructed area that can be easily accessed in case of an emergency.
- Exit signs should be placed above or next the doorway of an established fire exit so that its view is unobstructed by any shelter accessories.
- Smoke/CO detectors should be placed in a central overhead location within the shelter in an area that is unobstructed by any shelter accessories.

Storage

- All components should be stored in the protective case when not in use.
- Before returning the exit sign to the protective case, hit the reset button to turn off the battery backup system and prevent draining of the battery while stored.
- Smoke/CO detector should be tested regularly by certified safety officer or other regulatory body to ensure compliance with local regulations
- Fire Extinguishers should be inspected by certified safety officers or other regulatory bodies to ensure compliance with local regulations.

For any Questions or Troubleshooting, please contact your DLX Sales Ambassador or the Support team at (541) 357-5978